

USER MANUAL

TARGET BLU EYE 2 LCD DISPLAY



TARGET
BLU EYE 2

Know what's out there...



CONTENT

THE INTRODUCTION OF TARGET BLU EYE 2	3
DETECTION DISPLAY/SIGNAL STRENGTH METER	4
VISUAL AND ACOUSTIC ALERTS FOR APPROACHING EMERGENCY SERVICES	4
MUTE	5
CITY MODE	6
VOLUME	8
AUDIO MODE	9
BRIGHTNESS	10
INSTALLER MODE	11
DIM-ON-RED	12
ENABLE/DISABLE CHANNEL NUMBER DISPLAY	13
DARK MODE	14
RESET TO FACTORY SETTINGS	15
INFORMATION ABOUT HARDWARE AND SOFTWARE	16
MEMORY FUNCTION FOR ON/OFF	17
ERROR MESSAGES	17

INTRODUCTION

Thank you for choosing Target Blu Eye 2. With Target Blu Eye, you will always be alerted well in advance of approaching emergency services, including ambulances, fire trucks, police, and unmarked surveillance vehicles, even when they are traveling at high speed without flashing lights or sirens.

Emergency services use so-called Tetra radio systems. Once the radio in an emergency vehicle is activated, it periodically sends ultra-short pulses to the antenna towers in the C2000 network. These pulses are detected by Target Blu Eye and converted into an alert signal.

As a result, Target Blu Eye significantly enhances your safety, the safety of emergency services, and the safety of your fellow road users.

DETECTION DISPLAY/SIGNAL STRENGTH METER



The display automatically starts in detection mode after the ignition is switched on. On the left side of the screen, the blue laser icon indicates the connection with LaserTrack.



VISUAL AND ACOUSTIC ALERTS FOR APPROACHING EMERGENCY SERVICES

When an emergency service approaches, you will receive the following alerts:

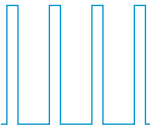
- The bars of the signal strength meter light up from green to red. Green (a weak signal) indicates a greater distance to the emergency service. Red (a strong signal) means the emergency service is in your immediate vicinity. The signal strength meters can display up to three different emergency services simultaneously, each with its own signal strength. It is possible that one vehicle emits two equally strong signals. This could indicate that there are two emergency personnel in the vehicle, each carrying a radio.
- An audible warning signal will also be heard.

Communication Method	Acoustic Warning Signal Target Blu Eye	Explanation
Periodic Registration	Short, repetitive, usually at 4-second intervals 	Emergency service vehicles periodically register with the nearest C2000 tower, even if the mobile phone/radio is not being used for communication. This periodic registration is recognized by Target Blu Eye. You will be alerted by a short, repetitive signal (usually every 4 seconds).
Communication and Data Messages	Repetitive Interval: Double Tone Within One Second 	When emergency services communicate with each other or with the control room, Target Blu Eye recognizes this. You will be alerted by a double tone within one second. This also applies when data messages are sent from the emergency service vehicle.

MUTE

This suppresses the acoustic alarm.

TEMPORARY MUTE

Tap the screen once briefly to activate **TEMPORARY MUTE**: a short sound signal will be heard, and a diagonal white line will appear through the speaker icon.

The **TEMPORARY MUTE** status remains activated for 30 seconds after the last alert. Upon a new alert, you will automatically be alerted again by the acoustic signal.



CONTINUOUS MUTE

Tap the screen twice briefly to activate **CONTINUOUS MUTE**: two short sound signals will be heard, and a white cross will appear through the speaker icon.

The **CONTINUOUS MUTE** status remains activated for the entire journey. Tapping the screen again briefly or reactivating the ignition will disable **CONTINUOUS MUTE**.



CITY MODE

In **CITY MODE**, a threshold value for alerts is set. Signals up to and including this threshold value are displayed only visually. This setting is recommended in urban areas where there are many and strong emergency service signals.

CITY MODE is set as follows: tap on the right side of the screen (red outlined in the image).



The following screen appears.

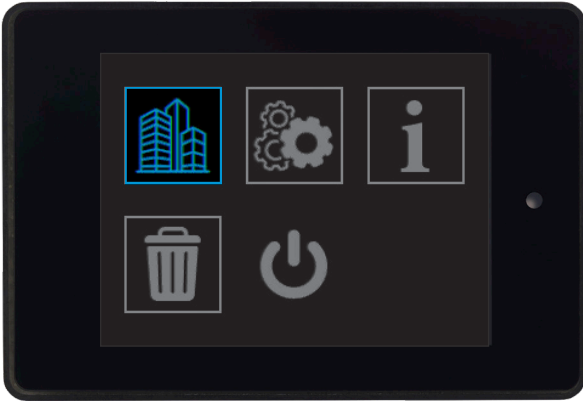

Tap on **CITY MODE**:
the **CITY MODE** setting appears. In the example, **CITY MODE** is set to a threshold value of two signal bars.



Tap twice on the right side of the screen: the display returns to the detection view. The set threshold value is displayed.

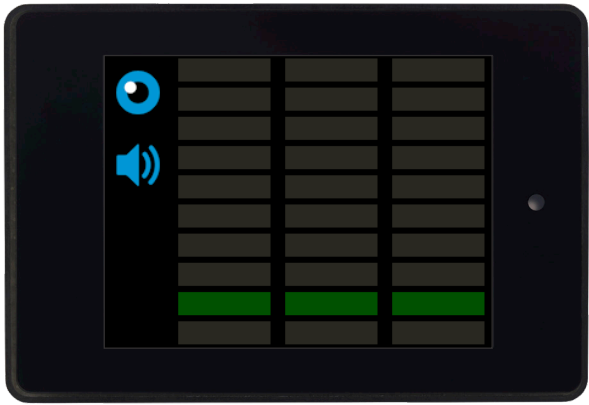

VOLUME

Tap on the right side of the screen: the main settings screen appears.

Tap on **SETTINGS**:



The following screen appears.



Tap on **VOLUME:**
the volume can be set in 10 steps.

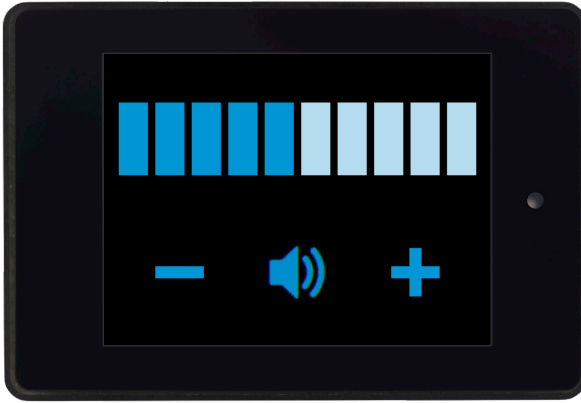

AUDIO MODE

You can choose from two different acoustic alarms:

1. **Standard**

Regardless of the signal strength, a warning signal is audible once every 4 seconds upon detection.

2. **Adaptive**

Depending on the signal strength, a single, double, or triple warning signal is audible.

- Green: single warning signal
- Yellow: double warning signal
- Red: triple warning signal

Tap briefly on the speaker icon to select the desired audio mode:

- 1 speaker icon: standard mode
- 3 speaker icons: adaptive mode



Tap on the right side of the screen to return to the previous display.

BRIGHTNESS



The brightness can be set in 10 steps.

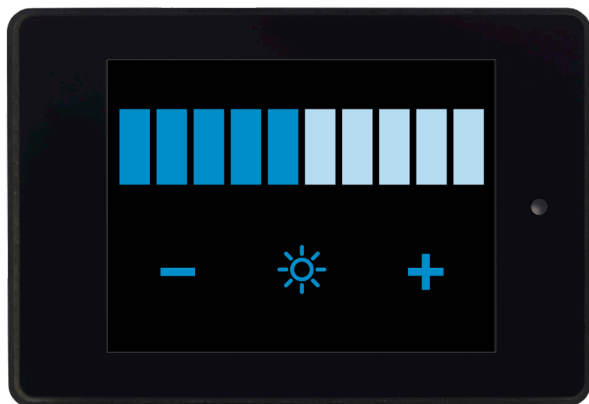

Tap on the right side of the screen to return to the previous display.

INSTALLER MODE



With **INSTALLER MODE**, the optimal location for the Blu Eye antenna can be determined. All details about this can be found in the 'Installation Manual' under the 'Downloads' section on the Blu Eye website.

DIM-ON-RED



DIM-ON-RED automatically turns off the entire display at a very strong signal (red). When the LCD display is mounted in a location visible to other traffic, this function is intended to minimize distraction to vehicles approaching from behind.

Tap briefly on the **DIM-ON-RED** icon to enable or disable this function.

DIM-ON-RED disabled:



DIM-ON-RED active:



NOTE!

When **TEMPORARY MUTE** or **CONTINUOUS MUTE** is selected and **DIM-ON-RED** is active, an acoustic alert will still be given during **DIM-ON-RED** when the display turns off.

ENABLE/DISABLE CHANNEL NUMBER DISPLAY

When **CHANNEL NUMBER DISPLAY** is enabled, the channel number is displayed at the bottom of each channel. A letter appears before the channel number: L (low) indicates the low band, while H (high) indicates the high band.

Tap briefly on the channel number display icon to enable or disable this function.



CHANNEL NUMBER DISPLAY disabled::



CHANNEL NUMBER DISPLAY active::



DARK MODE

When **DARK MODE** is selected, the LCD display turns off 15 seconds after the last alert. Once a new alert comes in, the display will automatically turn on. Tapping once on the screen will also turn the display on.



DARK MODE disabled:



DARK MODE active:



RESET TO FACTORY SETTINGS

This removes laser protection. Use this function when traveling to a country where laser protection is not allowed.

Tap on **REMOVE**:

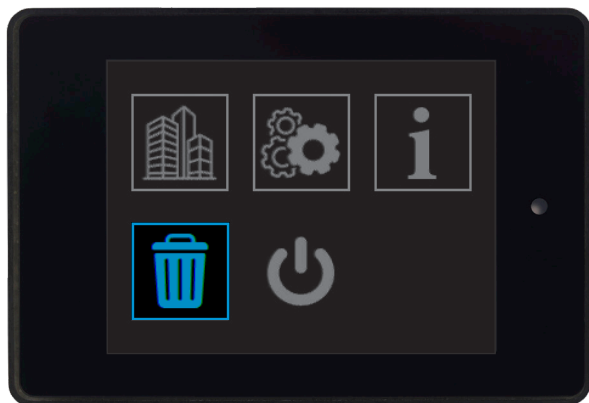

The following screen appears. Tap on the red cross to cancel. Tap on the green checkmark to confirm.

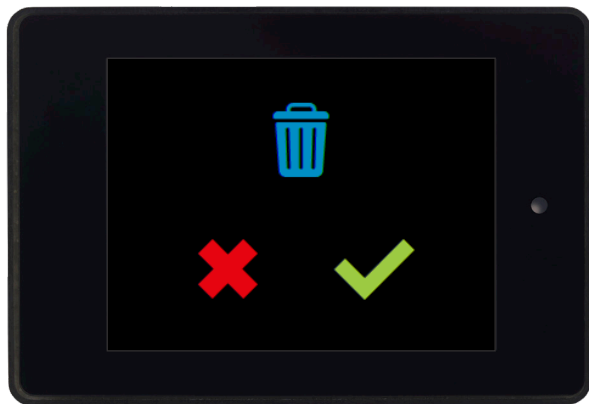

- A multi-tone audio signal sounds for 5 seconds.
- The trash bin icon blinks.
- Laser protection and laser detection have now been cleared.

INFORMATION ABOUT HARDWARE AND SOFTWARE

Tap on **INFORMATION**:



All data about hardware and software versions will be displayed.

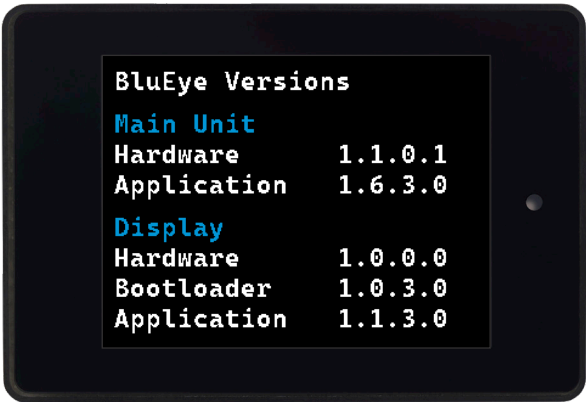

MEMORY FUNCTION FOR ON/OFF

Tap on **TURN OFF** to disable the system. When the vehicle's ignition is turned back on, the system remains disabled. You can re-enable the system by tapping once briefly on the screen.

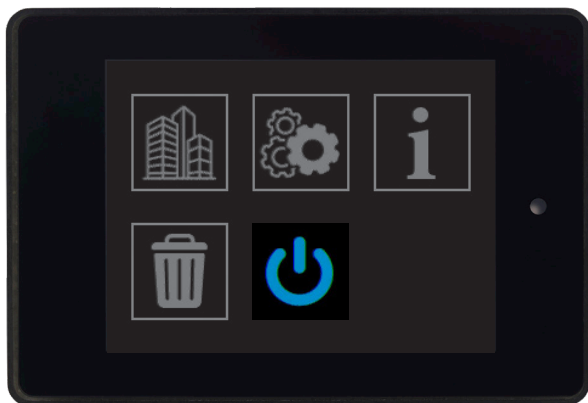

ERROR MESSAGES

Blu Eye performs a self-diagnosis. If a malfunction occurs unexpectedly, a warning tone sounds, and the Blu Eye logo temporarily turns red. If this message persists, please contact your supplier.





Zuidergracht 19 | 3763 LS Soest | the Netherlands
info@tracktechnologies.nl | +31 (0)35 760 5760
www.tracktechnologies.nl | www.blu-eye.eu